

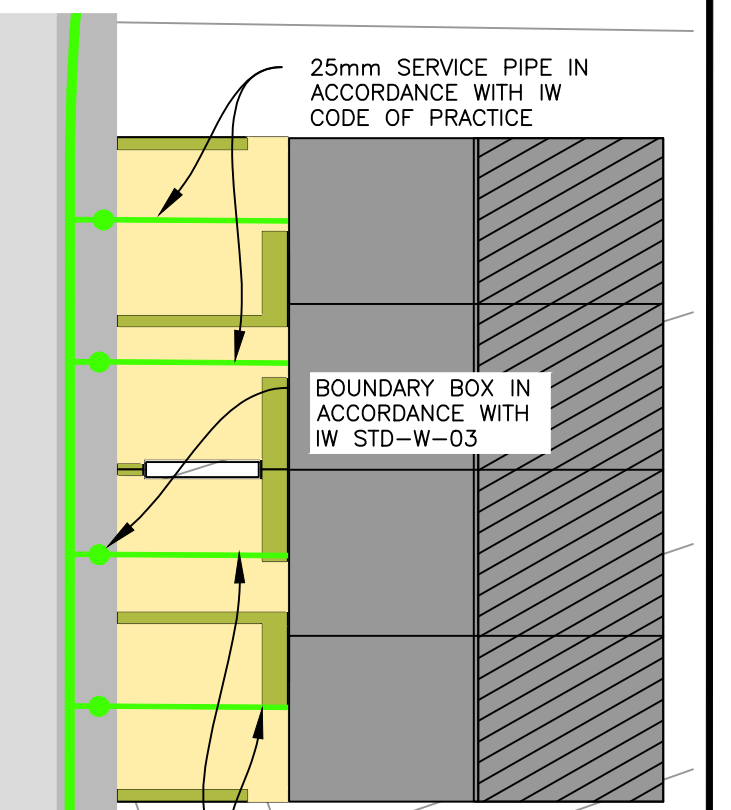

- NOTES:**
- THIS DRAWING TO BE READ IN CONJUNCTION WITH ALL RELEVANT ENGINEER'S AND ARCHITECT'S DRAWINGS AND SPECIFICATIONS.
 - FOR FULL SETTING OUT REFER TO ARCHITECT SETTING OUT DRAWINGS
 - WATERMAIN TO HAVE MINIMUM 900mm COVER.
 - FOR WATERMAIN TRENCH & BEDDING DETAILS REFER TO IW STD-W-13 REV1
 - FOR IRISH WATER STANDARD DETAILS REFER TO IW-CDS-5020-01 CONSTRUCTION REQUIREMENTS FOR SELF-LAY DEVELOPMENTS DECEMBER 2017 (REVISION 03)
 - AIR VALVES AND HYDRANT COVERS, WHERE LOCATED IN GRASS AREAS SHALL BE SURROUNDED BY A CONCRETE PLINTH, 200mm ALL AROUND AND 100mm DEEP FORMED WITH C20/25 CONCRETE, 20mm AGGREGATE SIZE, BEDDED IN CLAUSE 804 MATERIAL. PLINTH SHALL INCORPORATE MILD STEEL REINFORCEMENT LINKS AND SHALL HAVE A BULL NOSED FINISH AROUND ITS EXTERNAL PERIMETER IN ACCORDANCE WITH SECTION 3.18 WATER CODE OF PRACTICE
 - ALL WATERMAIN "T-JUNCTIONS" ARE IN ACCORDANCE WITH IW STD-W-07 REV1

- LEGEND:**
- PROPOSED HYDRANT CHAMBER TO IRISH WATER STD-18-REV2 TYPICAL
 - PROPOSED SLUICE VALVE CHAMBER TO STD-W-15-REV2 TYPICAL
 - PROPOSED SCOUR VALVE CHAMBER TO IW-STD-W-30 REV3
 - PROPOSED AIR VALVE CHAMBER TO STD-W-22-REV2 TYPICAL
 - PROPOSED CUSTOMER CONNECTION & BOUNDARY BOX TO IW-STD-W-03 REV 3
 - PROPOSED NON MECH METER CHAMBER TO IRISH WATER STD-W-26-REV3
 - PROPOSED WATERMAIN
 - EXISTING WATERMAIN



TYPICAL DETAIL OF CUSTOMER CONNECTION AND BOUNDARY BOX



KEY PLAN

<table border="1"> <tr> <td>ISSUED FOR PLANNING</td> <td>29.08.19</td> <td>DATE</td> <td>AWT</td> <td>AWT</td> </tr> <tr> <td>Revision</td> <td>Date</td> <td>By</td> <td>Chk'd</td> <td>App'd</td> </tr> </table>	ISSUED FOR PLANNING	29.08.19	DATE	AWT	AWT	Revision	Date	By	Chk'd	App'd	PLANNING			
ISSUED FOR PLANNING	29.08.19	DATE	AWT	AWT										
Revision	Date	By	Chk'd	App'd										
Client: CAIRN HOMES														
Project Title: PROPOSED HOUSING DEVELOPMENT AT FARRANKELLY, WICKLOW														
Drawing Title: PROPOSED WATERMAIN LAYOUT SHEET 2														
Drawing Number: FK-ROD-20-XX-DR-C-0042 Rev: P8														
Scale: 1:500	Date: SEPT 19	Job No: 16146	Cad File: J:\2016\16146\DWG											
Drawn: RE	Checked: MS	Approved: AWT	16146											

PLANNING